



PROJECT SIZE: ±14,613 SF
(±1,200 SF - ±4,800 SF)

ZONING:
C-2, City of Gilbert

POPULATION:
1 Mile - 6,723
3 Mile - 78,408
5 Mile - 222,298

HOUSEHOLD INCOME:
1 Mile - \$83,576
3 Mile - \$84,964
5 Mile - \$86,057

TRAFFIC COUNTS:
N/S on Val Vista - 32,000 VPD
East on Loop 202 - 53,000 VPD
West on Loop 202 - 62,000 VPD

Located in a high growth area of Gilbert, AZ

Property is located on Val Vista, immediately off the Loop 202 freeway

Directly across the street from the new Gilbert Mercy Medical Center with over 870 employees

100,000 SF of office buildings and daytime employment on the same property

Highly visible location on hard corner

Call for rates

COPPER POINT

SWC Loop 202 / Val Vista Drive | Gilbert, AZ

**Cassidy
Turley** BRE
Commercial

Chris Hollenbeck
Senior Associate
602.224.4475
chollenbeck@brephoenix.com

Cliff Johnston
Senior Vice President
602.224.4445
cjohnston@brephoenix.com

John Appelbe
Senior Vice President
602.224.4447
jappelbe@brephoenix.com

COPPER POINT

SWC Loop 202 / Val Vista Drive | Gilbert, AZ

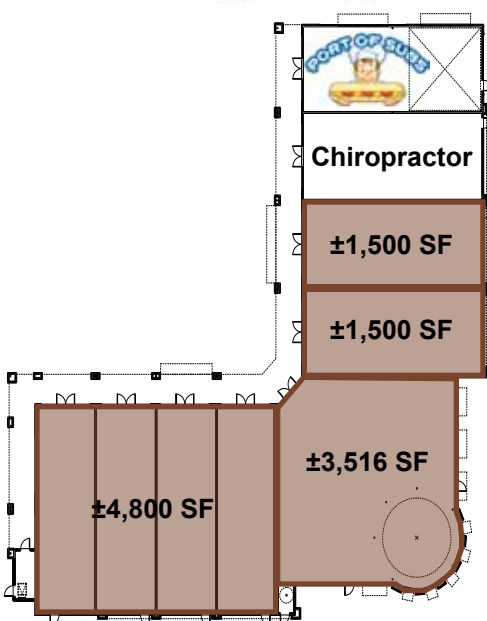

Cassidy
Turley BRE Commercial

Chris Hollenbeck
Senior Associate
602.224.4475
chollenbeck@brephoenix.com

Cliff Johnston
Senior Vice President
602.224.4445
cjohnston@brephoenix.com

John Appelbe
Senior Vice President
602.224.4447
jappelbe@brephoenix.com

2375 East Camelback Road, Suite 300 | Phoenix, Arizona 85016 | 602.954.9000 • FAX 602.468.8588 | www.brephoenix.com

This information contained within this brochure has been obtained from sources other than Cassidy Turley BRE Commercial. Cassidy Turley BRE Commercial has not verified such information and makes no guarantee, warranty or representation about such information. It is your responsibility to independently confirm its accuracy and completeness. Any dimensions, specifications, floor plans and information may not be accurate and should be verified by you prior to the lease or purchase of the property. The value of this transaction to you depends on economic and other factors which should be evaluated by your tax, financial and legal advisors. You and your advisor should conduct a careful, independent investigation of the property to determine to your satisfaction the suitability of the property for your needs.