

**SHOPS AND PADS
AVAILABLE FOR LEASE**

SITE



SEC Gantzel Road & Ocotillo Road

Queen Creek, Arizona

John Appelbe
Executive Vice President
602.224.4447
jappelbe@brephoenix.com

Cliff Johnston
Senior Vice President
602.224.4445
cjohnston@brephoenix.com

Chris Hollenbeck
Senior Associate
602.224.4475
chollenbeck@brephoenix.com

2375 E Camelback Rd Ste 300
Phoenix, Arizona 85016
p 602.954.9000
f 602.468.8588
www.brephoenix.com

**Cassidy
Turley** / BRE
Commercial

SEC Gantzel Road & Ocotillo Road Queen Creek, Arizona

FOR LEASE

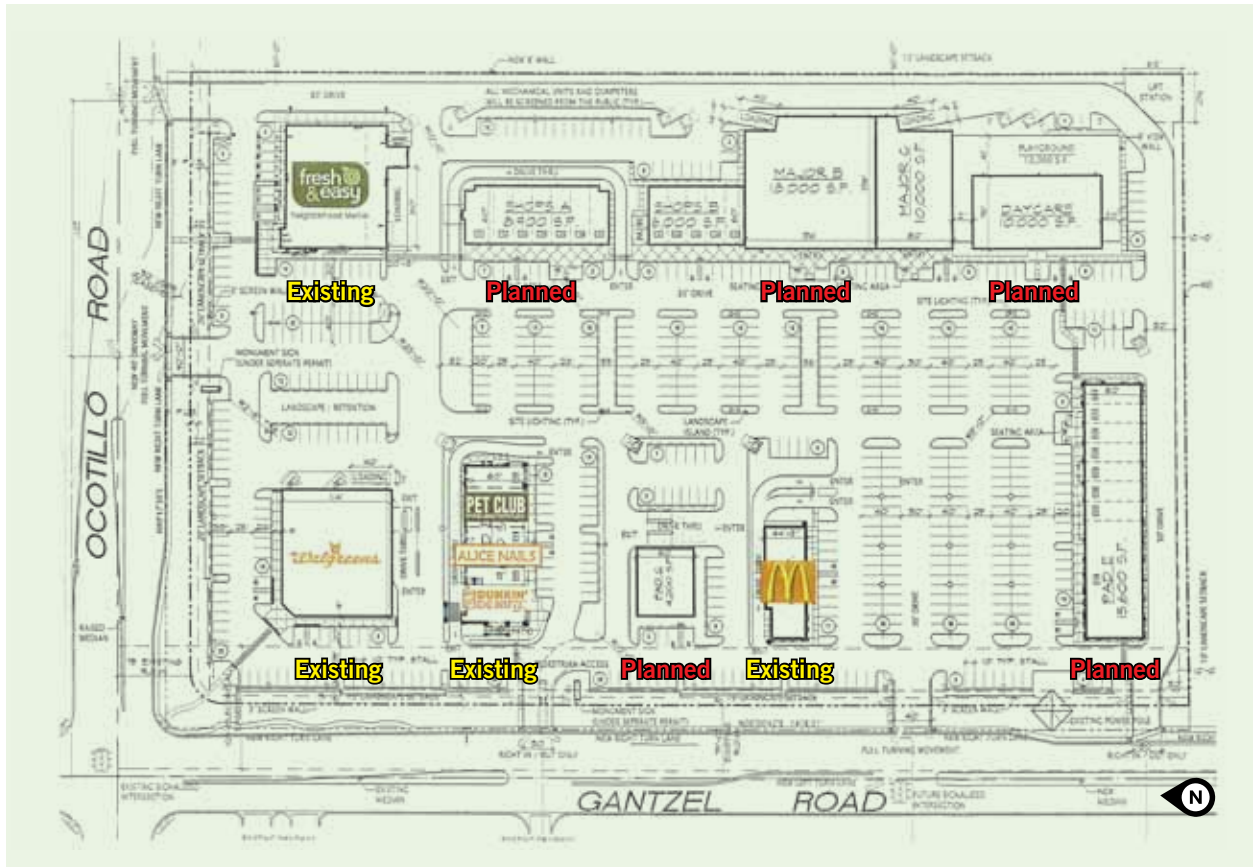

Property Features

- Walgreens Anchored Center
- Space Available For Lease
As Small as ±1,200 SF; As Large as ±28,000 SF
- Drive-thru Pads Available
- Daycare Center Site Available
- Lease Rate: Call for Rates
- Zoning: PAD, City of Queen Creek
- Traffic Counts: 67,975 VPD (Source: ESRI BAO 2010)
- All On-site Work Has Been Completed
- Lease, Sale and Build-to-Suit Opportunities Available

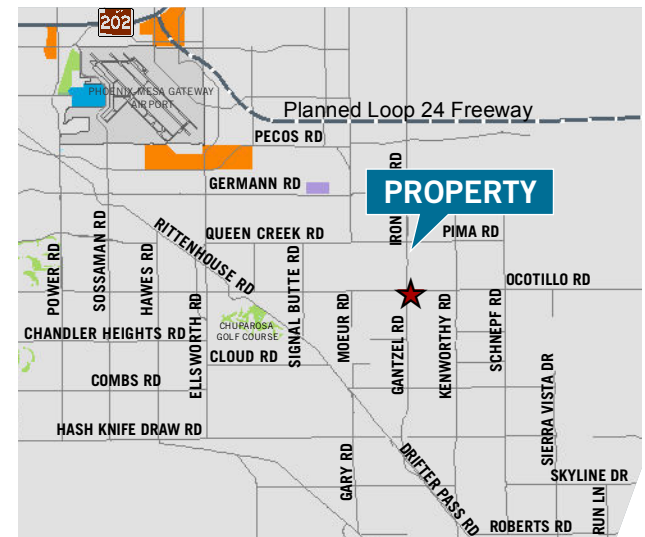

Demographics 2010

	1 Mile	3 Miles	5 Miles
Population	8,931	25,909	39,939
Average Income	\$57,115	\$59,351	\$63,387

Demographics Projected 2015

	1 Mile	3 Miles	5 Miles
Population	12,969	37,263	56,604
Average Income	\$64,863	\$67,213	\$71,411

For more information, please contact:

John Appelbe
Executive Vice President
602.224.4447
jappelbe@brephoenix.com

Cliff Johnston
Senior Vice President
602.224.4445
cjohnston@brephoenix.com

Chris Hollenbeck
Senior Associate
602.224.4475
chollenbeck@brephoenix.com

2375 E. Camelback Rd, Suite 300
Phoenix, Arizona 85016

ph: 602.954.9000
fx: 602.468.8588

www.brephoenix.com

**Cassidy
Turley** / BRE
Commercial