

±6,125 SF AVAILABLE



Former Superstition Springs Hooters Restaurant

6730 East Superstition Springs Boulevard | Mesa, Arizona

Chris Hollenbeck
Senior Associate
602.224.4475
chollenbeck@brephoenix.com

Cliff Johnston
Senior Vice President
602.224.4445
cjohnston@brephoenix.com

John Appelbe
Executive Vice President
602.224.4447
jappelbe@brephoenix.com

2375 E Camelback Rd Ste 300
Phoenix, Arizona 85016
p 602.954.9000
f 602.468.8588
www.brephoenix.com

Cassidy
Turley / BRE
Commercial

Former Hooters Restaurant

6730 East Superstition Springs Boulevard | Mesa, Arizona

Cassidy
Turley/BRE
Commercial

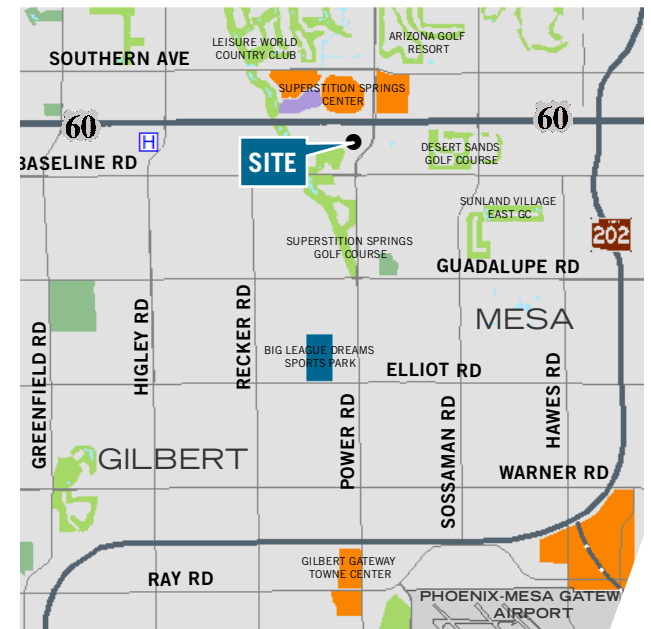



Floor Plan - ±6,125 SF

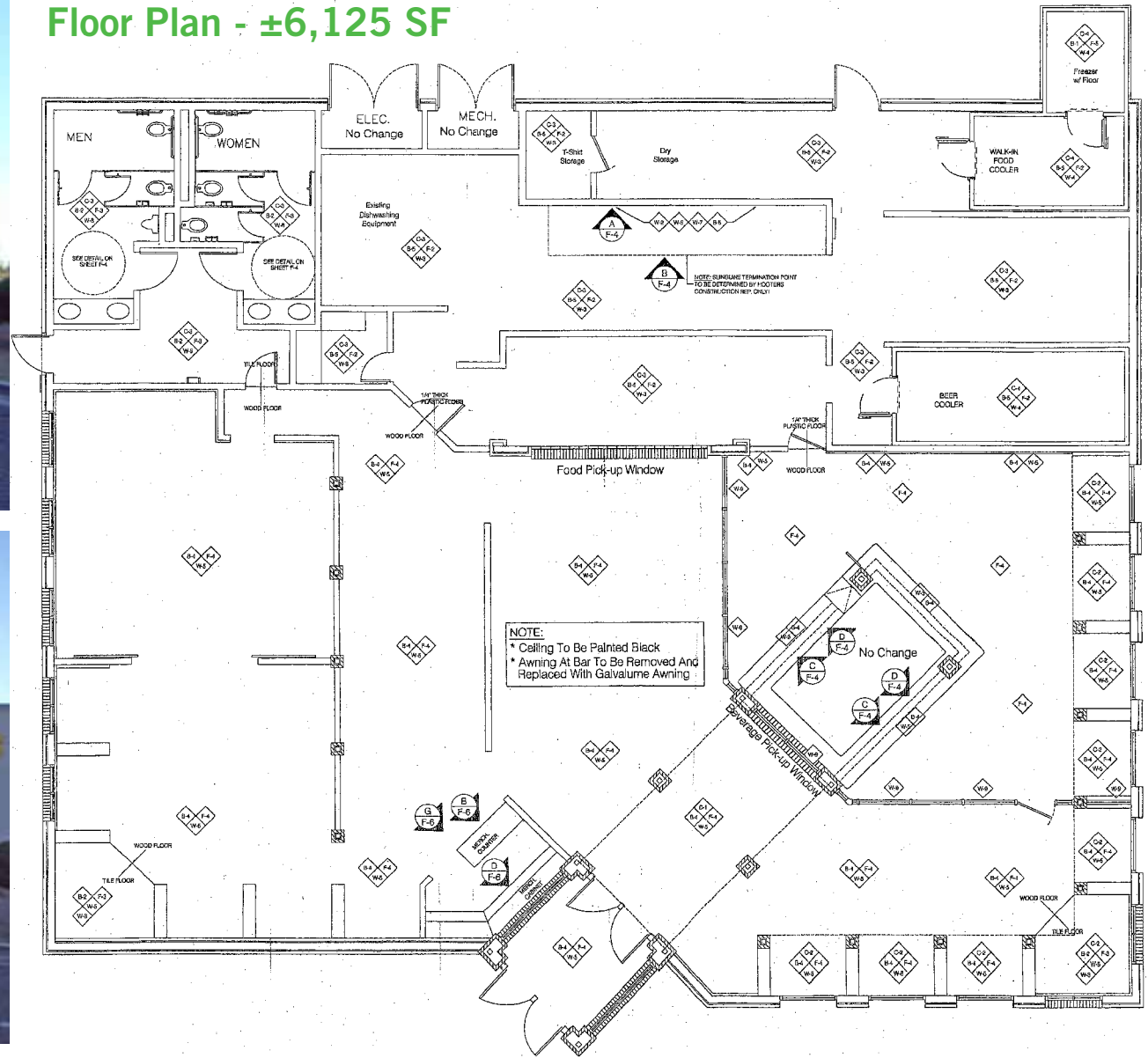

For more information, please contact:

Chris Hollenbeck
 Senior Associate
 602.224.4475
 chollenbeck@brephoenix.com

Cliff Johnston
 Senior Vice President
 602.224.4445
 cjohnston@brephoenix.com

John Appelbe
 Executive Vice President
 602.224.4447
 jappelbe@brephoenix.com

2375 E. Camelback Rd, Suite 300
 Phoenix, Arizona 85016
 ph: 602.954.9000
 fx: 602.468.8588
 www.brephoenix.com

**Cassidy
 Turley** / BRE
 Commercial

Former Hooters Restaurant

6730 East Superstition Springs Boulevard | Mesa, Arizona

Cassidy
Turley / BRE
Commercial

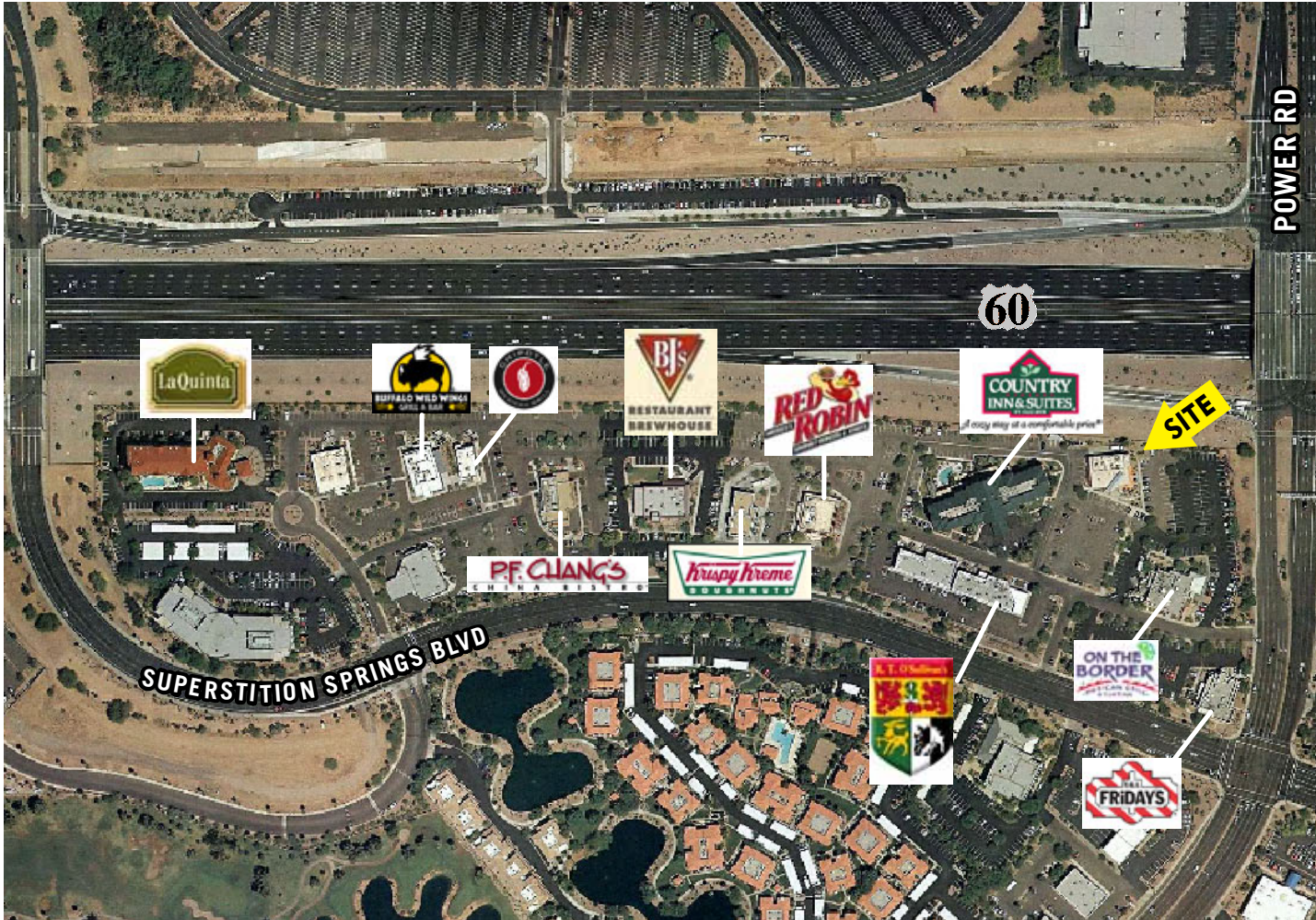

Features:

- ±6,125 SF Former Hooters Restaurant
- Fully fixtured including hood, walk in cooler and walk in freezer
- Located on Hotel & Restaurant Row in Superstition Springs
- Outdoor Patio
- Huge Parking Field
- Visible from US-60 Superstition Freeway

Demographics:

- **2010 Population**

1 mile	3 mile	5 mile
7,580	98,299	273,217
- **2010 Average Household Income**

1 mile	3 mile	5 mile
\$80,830	\$71,245	\$74,521
- **Traffic Counts**
 - N/S on Power Road - 76,600 VPD
 - E/W on US 60 - 308,800 VPD

For more information, please contact:

Chris Hollenbeck
Senior Associate
602.224.4475
chollenbeck@brephoenix.com

Cliff Johnston
Senior Vice President
602.224.4445
cjohnston@brephoenix.com

John Appelbe
Executive Vice President
602.224.4447
jappelbe@brephoenix.com

2375 E. Camelback Rd, Suite 300
Phoenix, Arizona 85016

ph: 602.954.9000
fx: 602.468.8588

www.brephoenix.com

Cassidy
Turley / BRE
Commercial