



Mesa Commons  
NWC Gilbert Road & Baseline Road  
Mesa, Arizona

Coming Soon - Tuesday Morning

Property Highlights:

- Available 1,000 SF, 1,560 SF, 1,800 SF and 3,000 SF
- \$15.00 PSF + \$3.24 NNN
- Zoning: C-2, City of Mesa
- Direct Freeway access to I-60
- Excellent Exposure
- Monument Signage

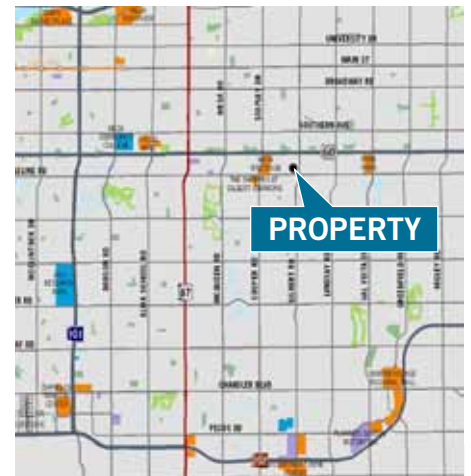

For more information, contact:

**Cliff H. Johnston**  
Senior Vice President  
602-224-4445  
cjohnston@brephoenix.com

**Chris Hollenbeck**  
Senior Associate  
602-682-8229  
chollenbeck@brephoenix.com



2375 E Camelback Rd Ste 300  
Phoenix, Arizona 85016

p 602.954.9000  
f 602.468.8588

[www.brephoenix.com](http://www.brephoenix.com)

# NWC Gilbert Road & Baseline Road

Mesa, Arizona

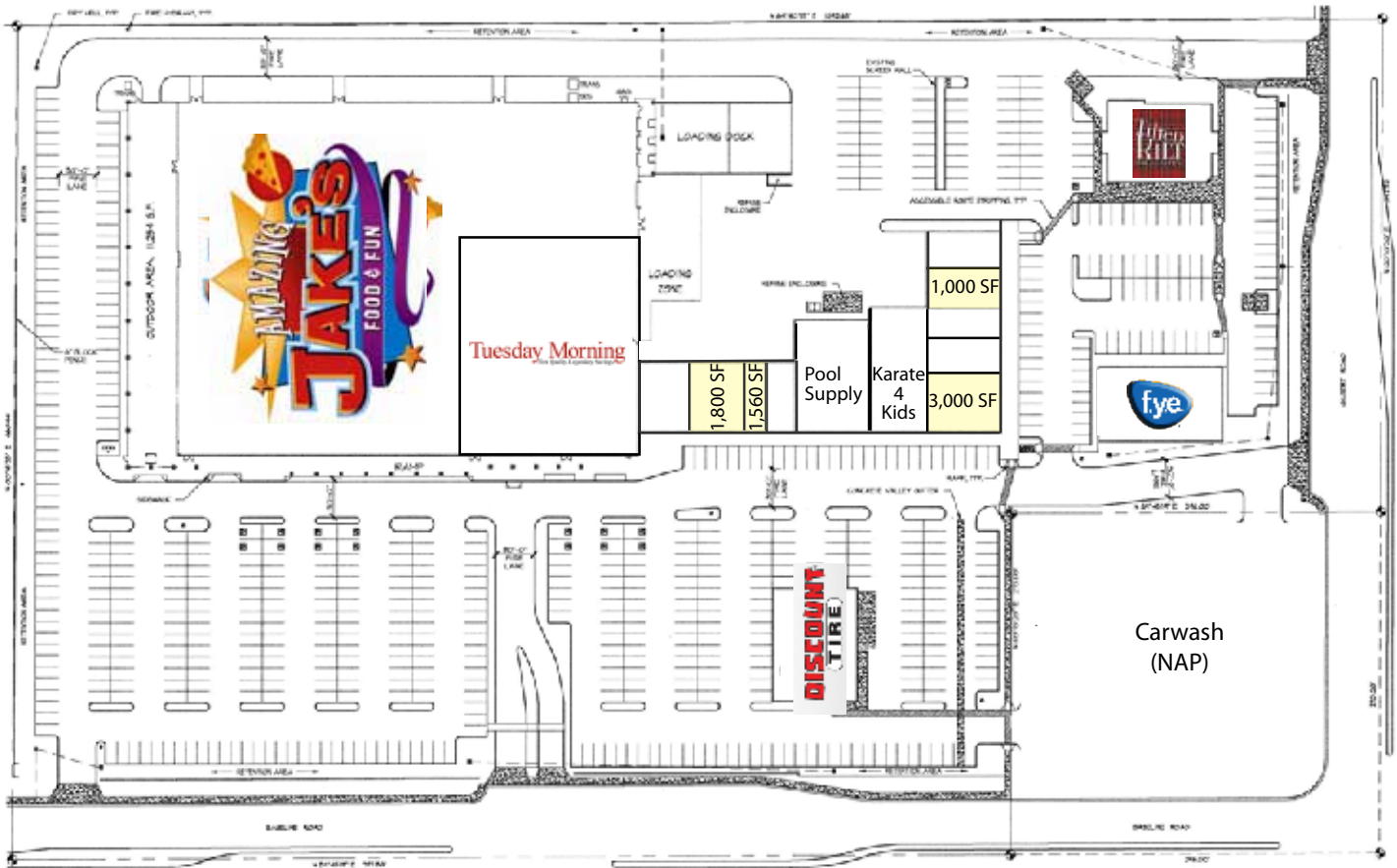

For more information, contact:

**Cliff H. Johnston**  
Senior Vice President  
602-224-4445  
cjohnston@brephoenix.com

**Chris Hollenbeck**  
Senior Associate  
602-682-8229  
chollenbeck@brephoenix.com

2375 E Camelback Rd Ste 300  
Phoenix, Arizona 85016

p 602.954.9000  
f 602.468.8588

[www.brephoenix.com](http://www.brephoenix.com)