

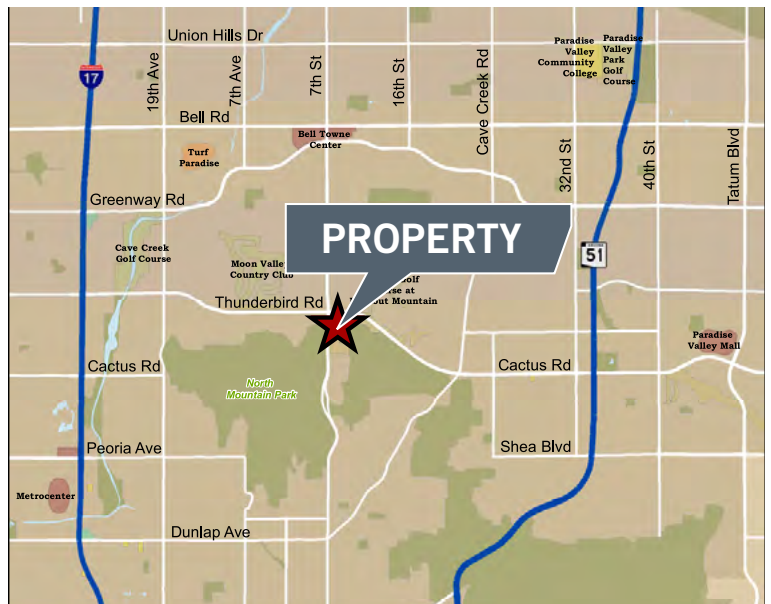

## FOR LEASE

### Property Highlights:

- Project Size: ±7,415 SF
- Available Shop Space: 1,200 SF
- Zoning: C-1
- Lease Rate: Call for rate



For more information, please contact:

**John Appelbe**  
Executive Vice President  
602.224.4447  
jappelbe@brephoenix.com

**Cliff Johnston**  
Senior Vice President  
602.224.4445  
cjohnston@brephoenix.com

**Chris Hollenbeck**  
Senior Associate  
602.224.4475  
chollenbeck@brephoenix.com

2375 E. Camelback Rd, Suite 300  
Phoenix, Arizona 85016

ph: 602.954.9000  
fx: 602.468.8588

[www.brephoenix.com](http://www.brephoenix.com)

## Site Plan

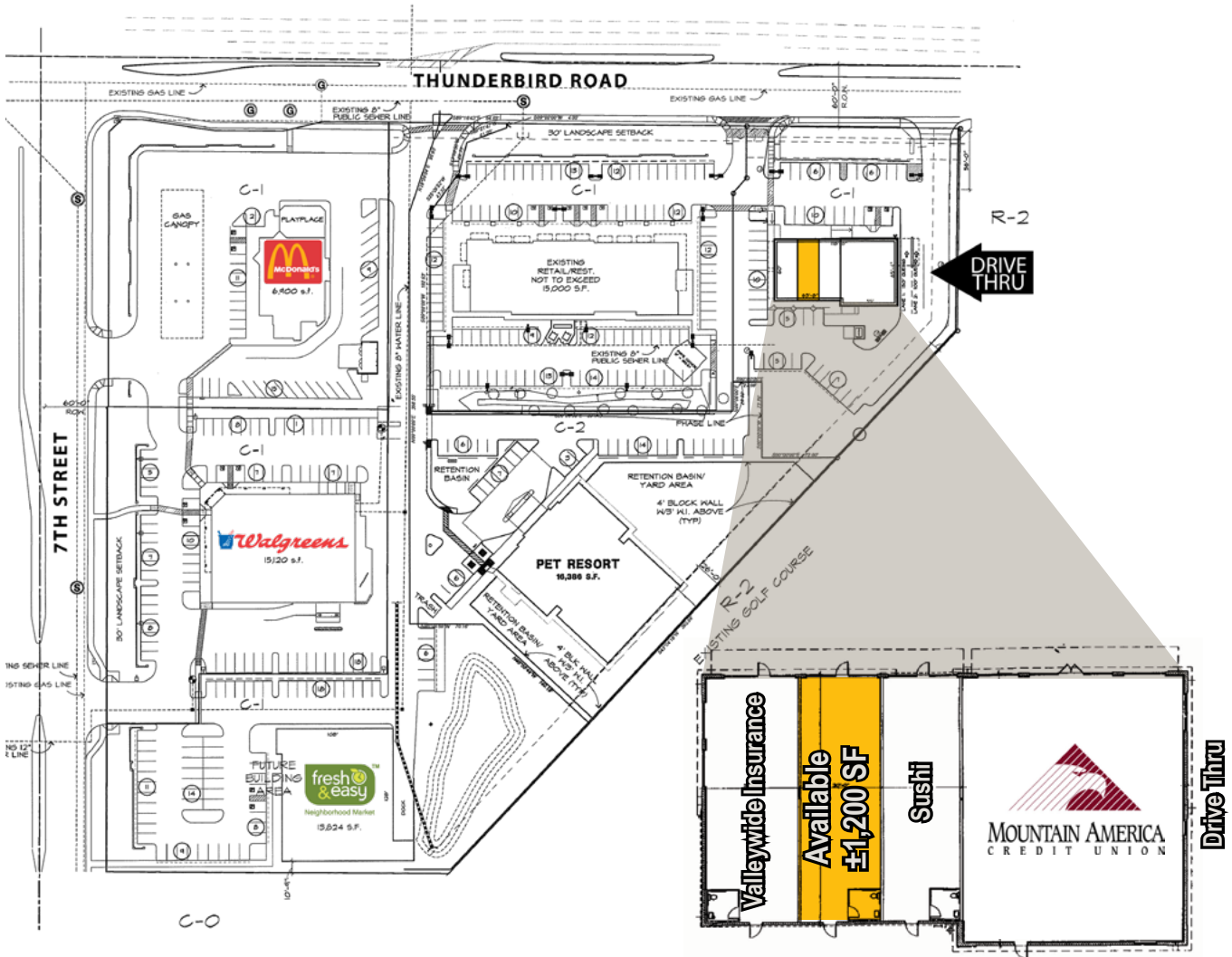

### Traffic Counts:

North on 7th St:	41,100 VPD
South on 7th St:	35,900 VPD
East on Thunderbird Rd:	44,000 VPD
West on Thunderbird Rd:	53,600 VPD

### Demographics:

	1 MILE	3 MILE	5 MILE
Population (2010 Estimate)	7,344	132,922	380,550
2010 Average Household Income	\$114,007	\$73,059	\$72,652

For more information, please contact:

**John Appelbe**  
Executive Vice President  
602.224.4447  
jappelbe@brephoenix.com

**Cliff Johnston**  
Senior Vice President  
602.224.4445  
cjohnston@brephoenix.com

**Chris Hollenbeck**  
Senior Associate  
602.224.4475  
chollenbeck@brephoenix.com

2375 E. Camelback Rd, Suite 300  
Phoenix, Arizona 85016  
ph: 602.954.9000  
fx: 602.468.8588

[www.brephoenix.com](http://www.brephoenix.com)