



Chandler Pavilions

SEC I-10 & Ray Road | Chandler, Arizona

Cliff Johnston
Senior Vice President
602.224.4445
cjohnston@brephoenix.com

Chris Hollenbeck
Senior Associate
602.224.4475
chollenbeck@brephoenix.com

2375 E Camelback Rd Ste 300
Phoenix, Arizona 85016
p 602.954.9000
f 602.468.8588
www.brephoenix.com

Cassidy
Turley / BRE
Commercial

Chandler Pavilions SEC I-10 & Ray Road | Chandler, Arizona

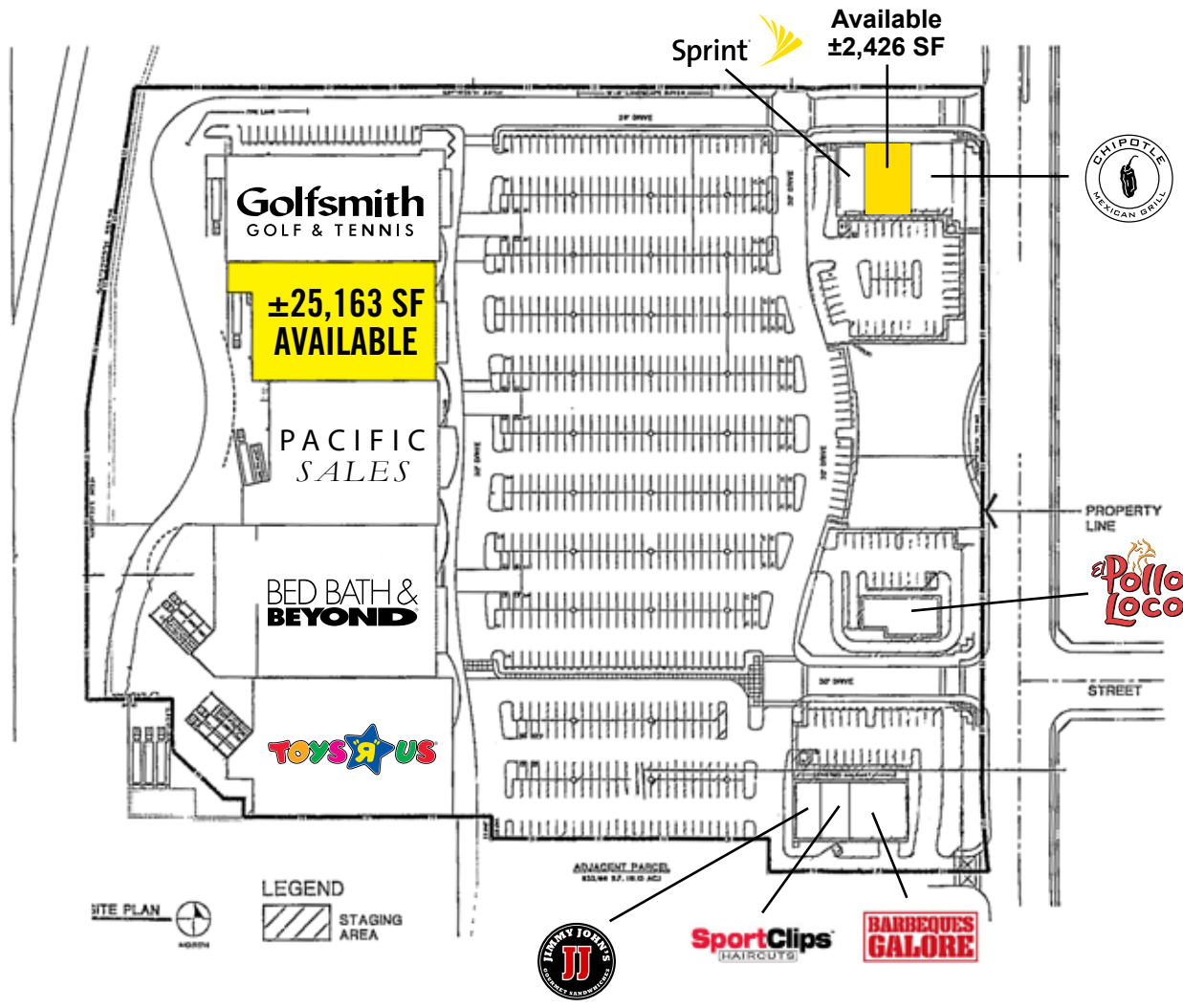

Demographics:

- Population

1 Mile	3 Miles	5 Miles
12,470	94,413	205,014
- Average Household Income

1 Mile	3 Miles	5 Miles
\$90,607	\$110,471	\$103,701
- Traffic Counts:
 - North/South on I-10: 170,000 VPD
 - East/West on Ray Road: 35,000 VPD



For more information, please contact:

Cliff Johnston
 Senior Vice President
 602.224.4445
 cjohnston@brephoenix.com

Chris Hollenbeck
 Senior Associate
 602.224.4475
 chollenbeck@brephoenix.com

2375 E. Camelback Rd, Suite 300
 Phoenix, Arizona 85016
 ph: 602.954.9000
 fx: 602.468.8588
www.brephoenix.com

Cassidy Turley / BRE Commercial