

SWC 43rd Avenue & Northern Avenue

Glendale, Arizona

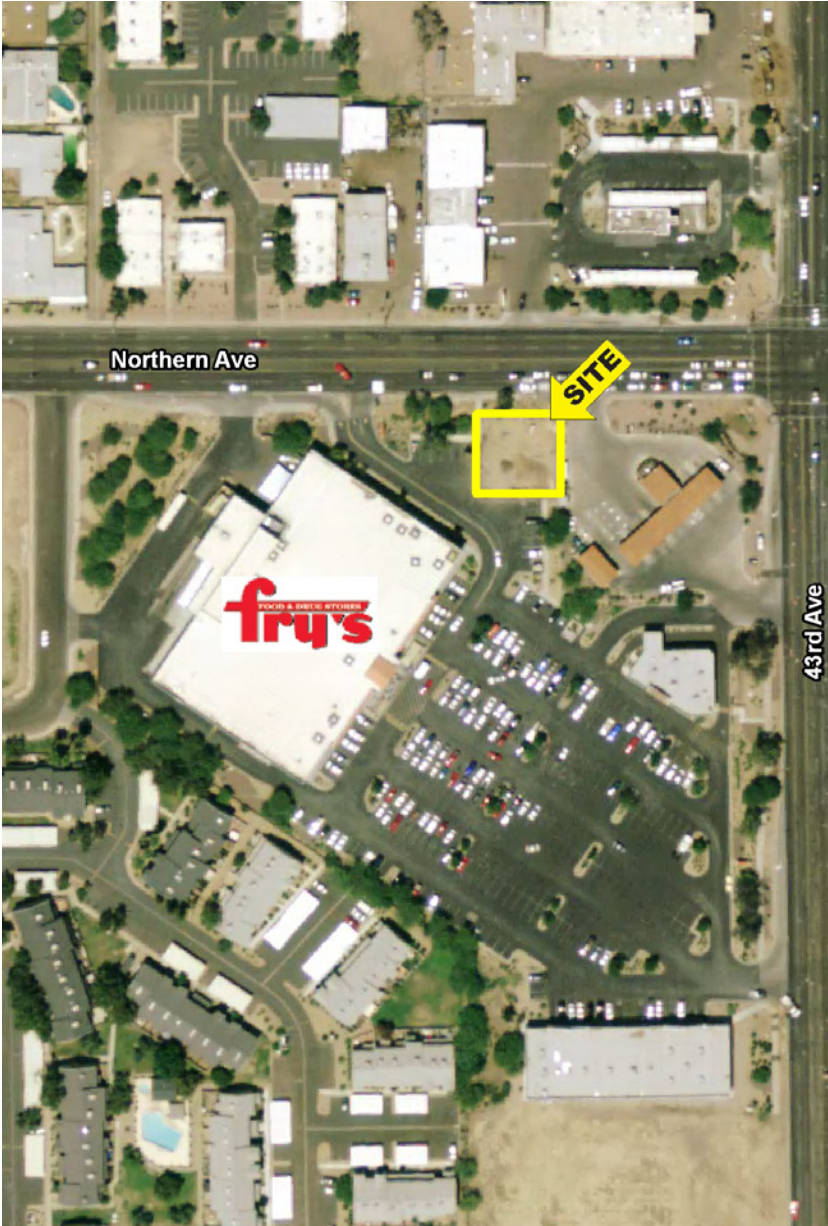

PAD FOR SALE



For more information, please contact:

Chris Hollenbeck
Senior Associate
602-224-4475
chollenbeck@brephoenix.com

Cliff Johnston
Senior Vice President
602-224-4445
cjohnston@brephoenix.com

John Appelbe
Executive Vice President
602-224-4447
jappelbe@brephoenix.com

2375 E. Camelback Rd, Suite 300
Phoenix, Arizona 85016
ph: 602.954.9000
fx: 602.468.8588
www.brephoenix.com

SWC 43rd Avenue & Northern Avenue

Glendale, Arizona

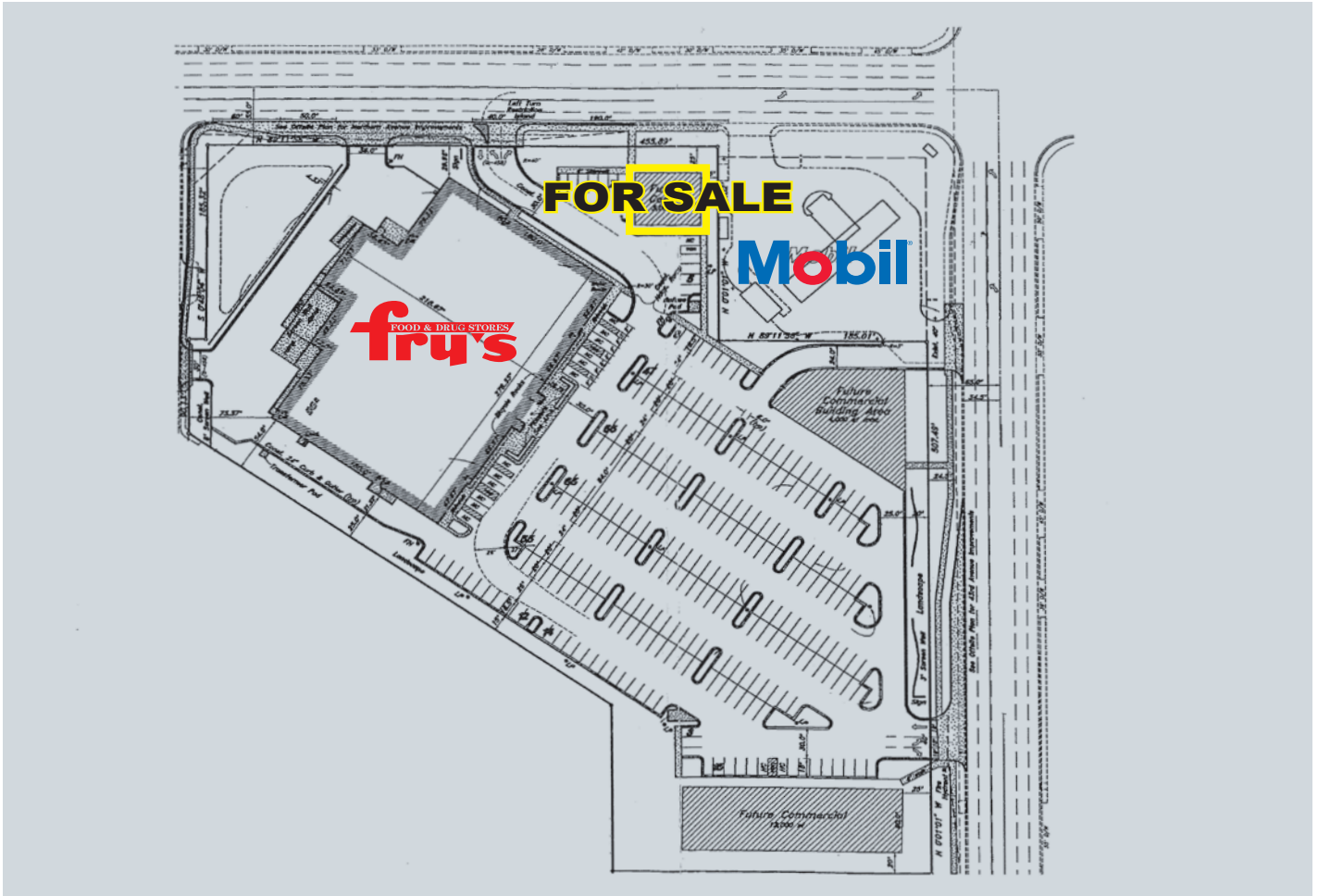

Property Highlights:

- | | | | | | | | | | | | | | | |
|--|---|----------------|-----------------|----------------|----------|--------|----------|----------|---------|----------|----------|---------|----------|---|
| <ul style="list-style-type: none"> • ±15,703 SF Pad For Sale • Zoned C-2, General Commercial • Grocery Anchored Pad • Perfect for Auto, Fast Food, etc. • ±3,000 SF of Buildable Area | <p>Demographics:</p> <table border="0"> <tr> <td></td> <td>2008 Population</td> <td>Avg. HH Income</td> </tr> <tr> <td>• 1 mile</td> <td>22,259</td> <td>\$62,949</td> </tr> <tr> <td>• 3 mile</td> <td>188,924</td> <td>\$57,692</td> </tr> <tr> <td>• 5 mile</td> <td>505,354</td> <td>\$62,122</td> </tr> </table> | | 2008 Population | Avg. HH Income | • 1 mile | 22,259 | \$62,949 | • 3 mile | 188,924 | \$57,692 | • 5 mile | 505,354 | \$62,122 | <p>Traffic Counts:</p> <ul style="list-style-type: none"> • N on 43rd Ave: 35,900 VPD • S on 43rd Ave: 31,900 VPD • E on Northern Ave: 34,700 VPD • W on Northern Ave: 38,000 VPD |
| | 2008 Population | Avg. HH Income | | | | | | | | | | | | |
| • 1 mile | 22,259 | \$62,949 | | | | | | | | | | | | |
| • 3 mile | 188,924 | \$57,692 | | | | | | | | | | | | |
| • 5 mile | 505,354 | \$62,122 | | | | | | | | | | | | |

For more information, please contact:

Chris Hollenbeck
Senior Associate
602-224-4475
chollenbeck@brephoenix.com

Cliff Johnston
Senior Vice President
602-224-4445
cjohnston@brephoenix.com

John Appelbe
Executive Vice President
602-224-4447
jappelbe@brephoenix.com

2375 E. Camelback Rd, Suite 300
Phoenix, Arizona 85016
ph: 602.954.9000
fx: 602.468.8588
www.brephoenix.com